



Horn Lane, London

LONG LET. Enjoying a great location close to local transport links, this three double bedroom flat boasts generous amounts of living space with a modern interior.

- THREE DOUBLE BEDROOMS
- LARGE PRIVATE TERRACE
- 2 BATHROOMS
- MASTER EN-SUITE BEDROOM
- CLOSE TO TRANSPORT LINKS
- CLOSE TO AMENITIES

£2,500

Horn Lane

Approximate Gross Internal Area
710 sq ft - 66 sq m

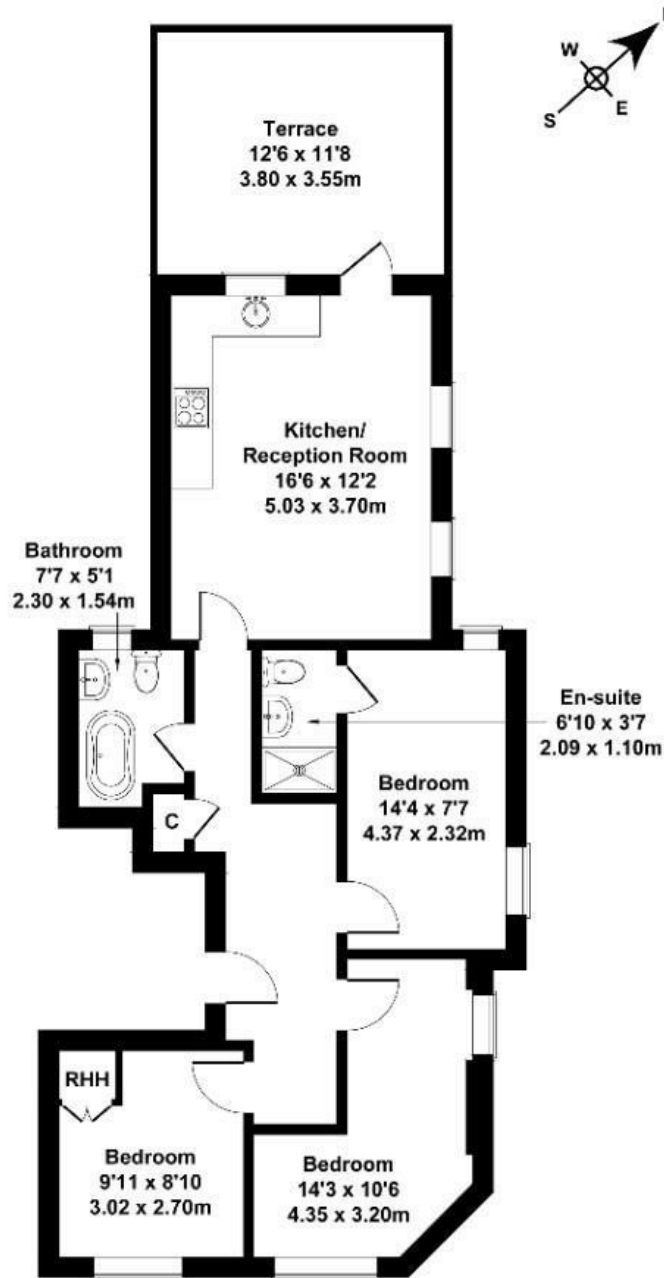

FIRST FLOOR

Not to Scale. Produced by The Plan Portal 2023
For Illustrative Purposes Only.

| Energy Efficiency Rating | | |
|---|---------|-------------------------|
| | Current | Potential |
| Very energy efficient - lower running costs | | |
| (92 plus) A | | |
| (81-91) B | | |
| (69-80) C | | |
| (55-68) D | 64 | |
| (39-54) E | | |
| (21-38) F | | |
| (1-20) G | | |
| Not energy efficient - higher running costs | | |
| England & Wales | | EU Directive 2002/91/EC |